

Instructions to Replace Refrigerant Leak Sensor Adapter Harness Kit for SVZ

Instructions to Replace Refrigerant Leak Sensor Adapter Harness Kit for SVZ

Checking parts: Service part number U61-003-084

- QTY 1: Refrigerant Leak Sensor cable harness



- QTY 1: Self-adhering foam strip

To replace Refrigerant Leak Sensor cable harness for SVZ indoor units only, please follow these instructions:



CAUTION

BEFORE STARTING THE REPLACEMENT, MAKE SURE THE UNIT IS DISCONNECTED FROM ALL POWER SOURCES!



NOTE

Most of the steps to be followed in these instructions are the same for the majority of mounting positions; those that differ from one position to another are noted as such.

1. Remove all front panel screws then remove blower panel and coil panel.

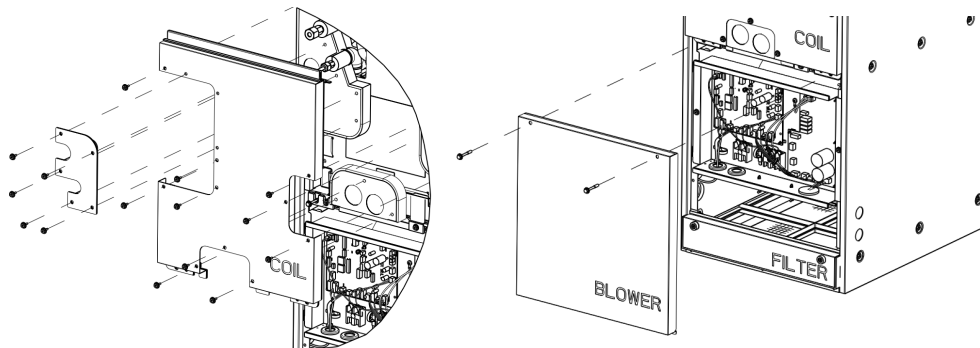

2. Remove small panels (as needed according to installed orientation) by sliding them out in the directions indicated below.

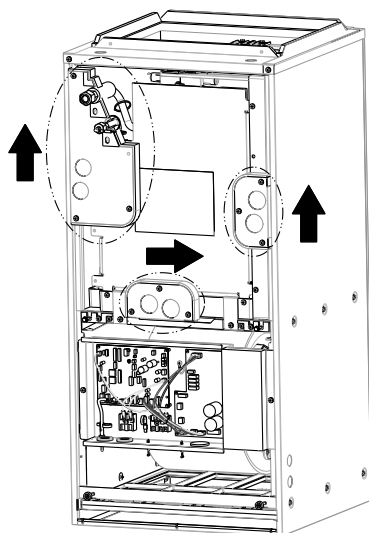

3. Unplug existing Refrigerant Leak Sensor harness from connector CNSA inside the control box.

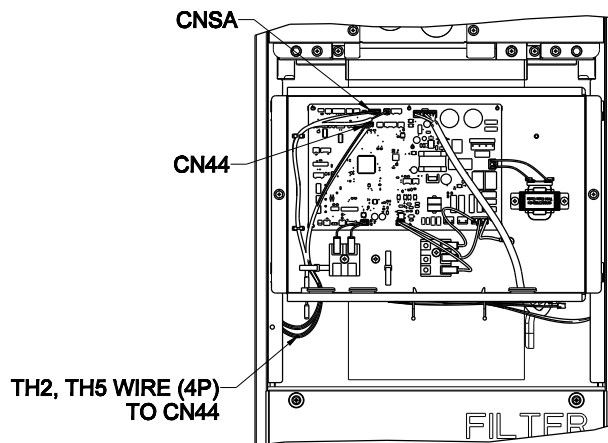

4. Remove screws (2) then remove the control box. If there is insufficient slack in the power and controller wires to move the control box out of the way then they may need to be disconnected at the terminal blocks.

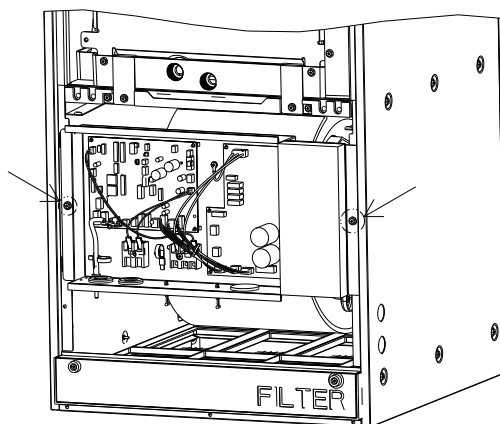

5. Cut off the connector of the existing Refrigerant Leak Sensor harness, then remove the existing harness out of the left panel by pulling it from the bottom.



6. Plug the new Refrigerant Leak Sensor harness into the Refrigerant Leak Sensor cable.

7.

A) For <u>UPFLOW, DOWNFLOW, HORIZONTAL RIGHT</u> installed orientations, the new Refrigerant Leak Sensor harness will be installed where the previous harness was installed.	B) For <u>HORIZONTAL LEFT</u> installations, the new Refrigerant Leak Sensor harness will be routed along the right panel as shown below.
---	--

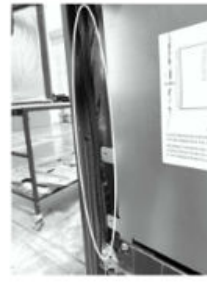

8. According to the installation position shown below, remove the indicated side panel screw.

**UPFLOW, DOWNFLOW, HORIZONTAL
RIGHT**

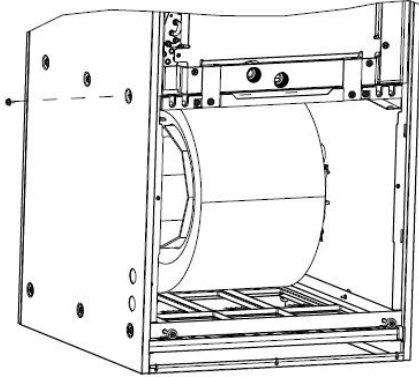

HORIZONTAL LEFT

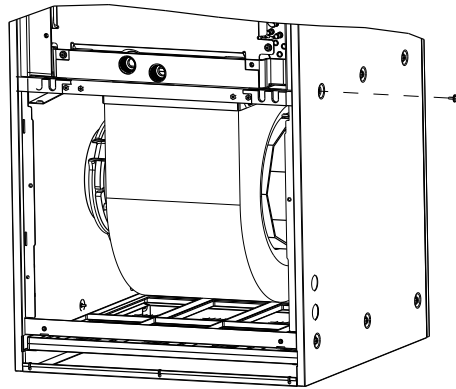

9. For **UPFLOW, DOWNFLOW, HORIZONTAL RIGHT** installations only, create a slit in the insulator along the RIGHT side of panel edge where the harness is tucked behind the flange.



10. According to installed position, separate slightly the panel from the fan support shelf.

**UPFLOW, DOWNFLOW, HORIZONTAL
RIGHT**



HORIZONTAL LEFT



11. According to installed position, separate slightly the panel from the fan support shelf.

**A) For UPFLOW, DOWNFLOW and
HORIZONTAL RIGHT installations, press
the new Refrigerant Leak Sensor harness
into the channel where the original harness
existed**



**B) For HORIZONTAL LEFT installations,
press new Refrigerant Leak Sensor
harness between panel and shelf and route
new harness along right panel edge.**



12. Plug new Refrigerant Leak Sensor harness into connector CNSA inside the control box by first feeding it through the left knockout. Be sure to tie up loose portions of the new Refrigerant Leak Sensor harness so it cannot get sucked into the fan assembly.

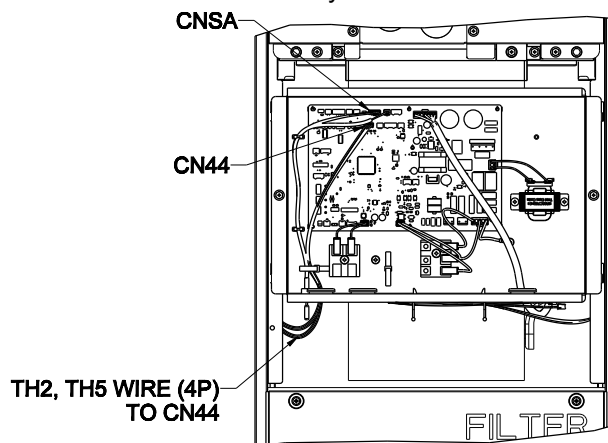

13. Secure the new Refrigerant Leak Sensor harness by removing release liner of the provided self-adhering foam strip and placing it over the new Refrigerant Leak Sensor harness.

**UPLFLOW, DOWNFLOW, HORIZONTAL
RIGHT**

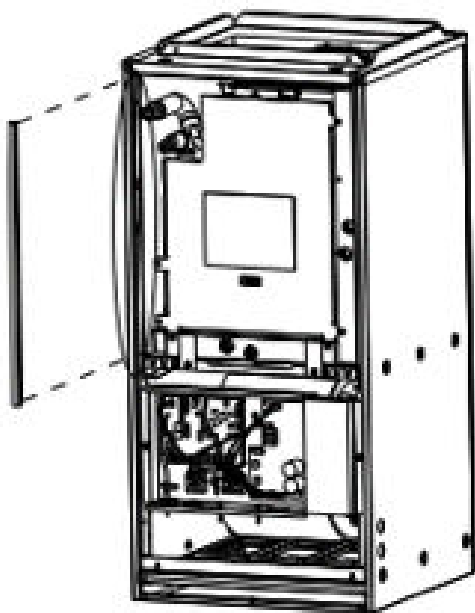

HORIZONTAL LEFT

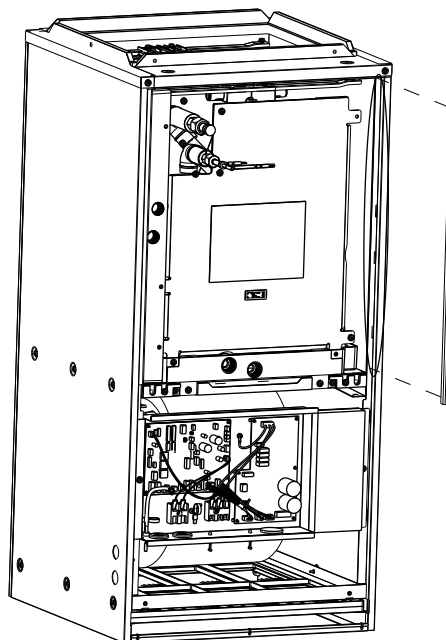

14. Reassemble unit by placing back side panel screws (reverse STEP 8). Continue to put back screws for the control box (STEP 4). Proceed to slide side panels back (STEP 2) and finalize with placement of front panel covers (STEP 1) with their respective screws.

This product is designed and intended for use in the residential, commercial and light-industrial environment.

MITSUBISHI ELECTRIC US, INC.

www.mitsubishielectric-usa.com

: